



FEATURES

- Accuracy $\pm 0.2\%$ R.O.
- Precision measurement even for unbalance system
- Precision measurement even for distorted wave
- High impulse & surge protection (5KV)
- The case can be mounted on a 35mm rail which complies with DIN 46277



DESCRIPTION

Model: S3-RHD-1 1 Φ 2W, VARHOUR
 S3-RHD-3 3 Φ 3W, VARHOUR
 S3-RHD-3A 3 Φ 4W, VARHOUR

For kilovar-hour-measurement, we build in another linear integrator circuit. This circuit accepts signal from Vars portion and integrates with respect to time, to produce a pulse output via volt free contacts, result in pulse proportional to kilovar-hours.

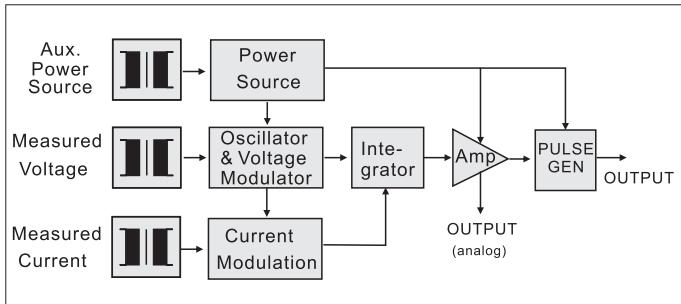

INPUT - OUTPUT CURVE

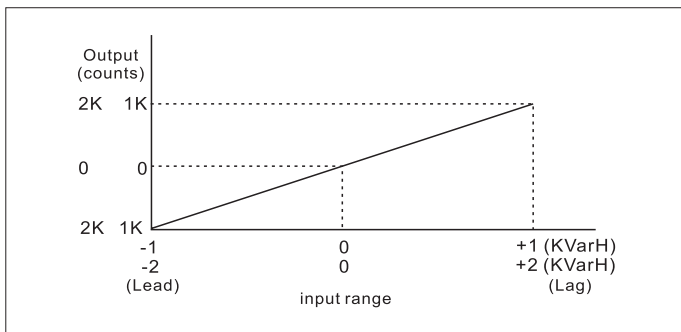

SPECIFICATION

INPUT

Input Range				Max. Input Over Capability
Circuit	Amp.	Voltage	Basic Watt	
Single Phase	5A	110V (120V)	± 0.5 KVarH	Ampere: 3 x rated continuous 10 x rated 10 sec. 50 x rated 1 sec. Voltage: 2 x rated continuous
		220V (240V)	± 1 KVarH	
3-Phase 3-Wire	5A	110V (120V)	± 1 KVarH	
		220V (240V)	± 2 KVarH	
3-Phase 4-Wire	5A	190V/110V (208/120V)	± 1.5 KVarH	
		380V/220V (416/240V)	± 3 KVarH	

OUTPUT

Output Range		Output Mode		
Per 1KVarH	100counts	Pulse	Open Collect	SPST Relay Contacts
	1000counts			
	10000counts	DC 15V, 10mA	DC 30V, 100mA	AC 110V, 0.5A DC 24V, 1A

Accuracy $\pm 0.2\%$ Rated of Output
 Input frequency 50HZ ± 3 HZ or 60HZ ± 3 HZ
 Input burden ≤ 0.1 VA (ampere input)
 ≤ 0.2 VA (voltage input)
 Aux. power source AC 110 V $\pm 15\%$, 50/60HZ
 AC 220 V $\pm 15\%$, 50/60HZ
 DC 24V, 48V, 110V $\pm 10\%$
 Power effect $\leq 0.1\%$ R.O.
 Power consumption AC ≤ 8 VA, DC ≤ 6 W
 Waveform effect $\leq 0.2\%$ R.O. at distortion factor 15%
 Electromagnetic balance effect $\leq 0.1\%$ R.O.
 Mutual interference effect $\leq 0.1\%$ R.O. between element
 Magnetic field strength $\leq 0.2\%$ R.O. 400A/M
 Span adjustment range $\leq 5\%$ R.O.
 Zero adjustment range $\leq 1\%$ R.O.
 Operating temperature range 0 ~ 60 °C
 Storage temperature range -10 ~ 70 °C
 Temperature coefficient ≤ 100 PPM, 25 °C ± 10 °C
 Max. relative humidity $\leq 95\%$
 Isolation Input/output/power/case
 Isolation resistance ≥ 100 M Ω , DC 500 V
 Dielectric withstand voltage Between input/output/power/case
 IEC 60688 AC 2.6 KV, 60 HZ, 1 minute
 Impulse withstand test 5KV, 1.2 \times 50 μ s
 IEC 61000-4-5 Common mode & differential mode
 Performance Designed to comply with IEC 60688



ORDER INFORMATION

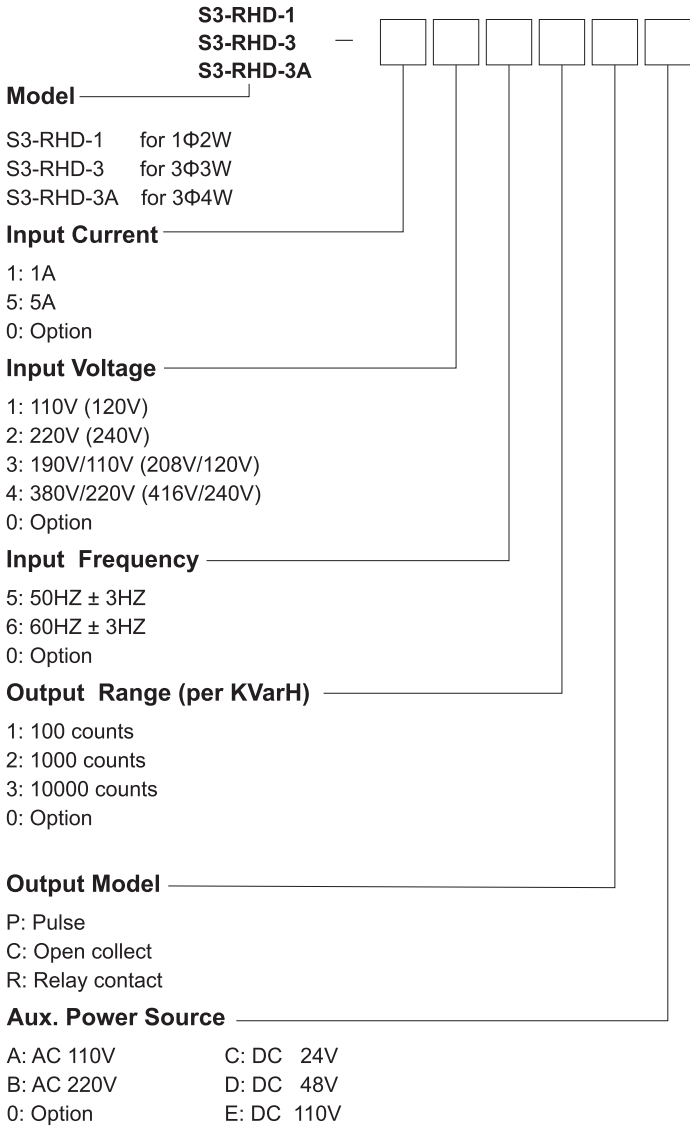

• PANEL MOUNTING HOLES (UNIT:mm)

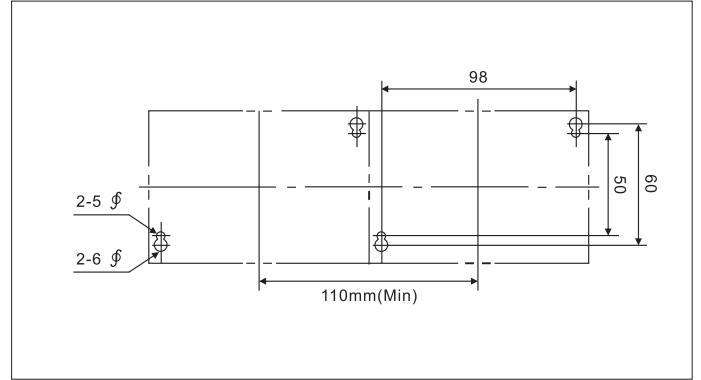

CONNECTION DIAGRAM

S3-RHD-1 (1Φ2W)

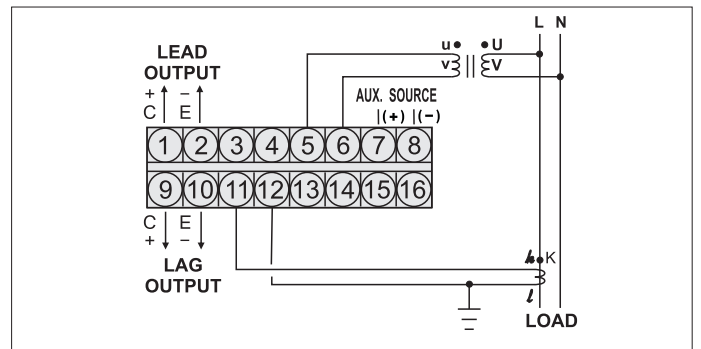

S3-RHD-3 (3Φ3W)

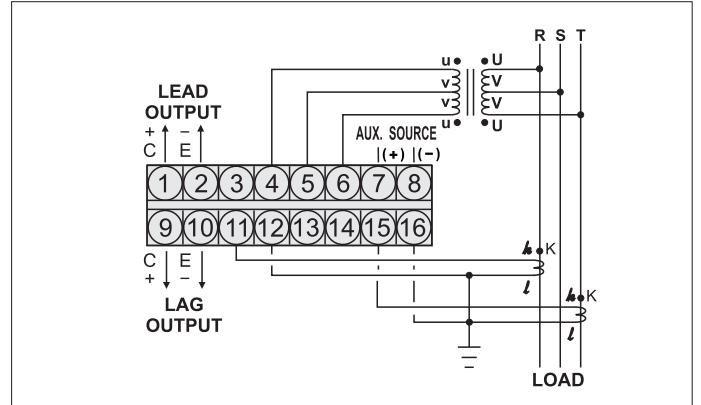

S3-RHD-3A (3Φ4W)

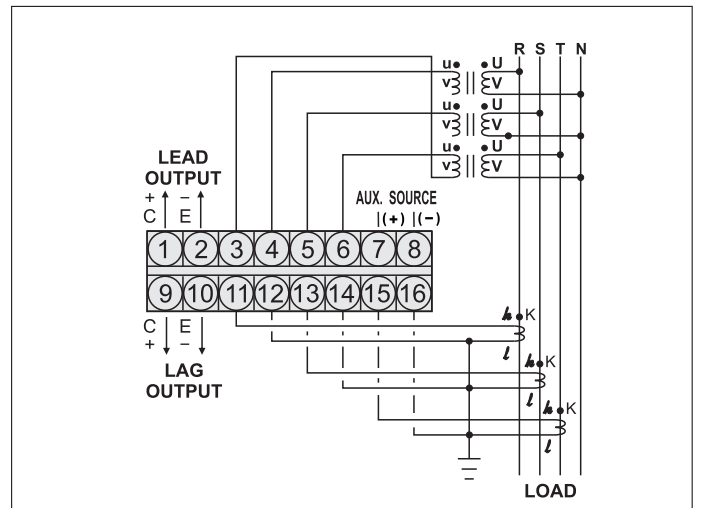

THE OUTSIDE DIMENSION (UNIT:mm)

